

316

SINHGAD TECHNICAL EDUCATION SOCIETY

CERTIFICATE FOR RELEASING THE CONTRACTORS/SUPPLIERS BILLS

15 DEC 2010

Title of the work : Tree Plantation (Kondhwa)Date : 27 10 2010W.O./P.O. No. and date P-162/09-10Original Value Rs : 71,281 00Name of the Contractor / Supplier Green GraphR.A Bill No. and Date : 2nd & FinalBill Amount as claimed : 71,281.00Brief Description of the work/materials now billed : Tree plantation and garden development work done at our Kondhwa campus.

The above works/supplies are found to be satisfactory.

The Contractors/Suppliers has been checked for the rates, quantity, quality/completeness of works/items.

The bill is certified for Rs. 71,281.00 for payment by the Architect

Cumulative amount passed for payment including above is Rs. _____

Shahar
Dealing clerk

[Signature]
Project Manager

Architect

I/C Accountant

The concerned Engineers /Architect have checked the details of the bill and recommended the bill for payment as detailed below.

| | | |
|---|-----|------------------|
| 1) The R A bill No : R A and Amount | Rs. | <u>71,281.00</u> |
| 2) Deduct recoveries if any | Rs. | _____ |
| 3) Gross Amount | Rs. | <u>71,281.00</u> |
| 4) Deduct Security Deposit/Retention 5% | Rs. | _____ |
| 5) Deduct Income Tax @ 1% | Rs. | <u>713.00</u> |
| 6) Deduct Vat @ 2% | Rs. | _____ |
| 7) Material Rate Difference | Rs. | _____ |
| 8) Amount recommended for payment | Rs. | <u>70,568.00</u> |

[Signature]
Director (Projects)
Sinhgad Technical Education Society

Secretary
Sinhgad Technical Education Society

[Signature]
Founder President
Sinhgad Technical Education Society

Amount paid with Details : Bank _____ Ch./D.D. No. _____

Date : _____

Accountant :

GREEN GRAPH

Plot No 3, Survey No 216, Baner, Pune, 411045

2nd and Final R.A.Bill

Date: 15/10/2010

To,
SINHAGAD TECHNICAL EDUCATION SOCIETY,
S.No 44/1, Vadgaon – Budruk,
Sinhgad road, Pune – 411041.

Sub: Tree Plantation and Garden Development at STES School, Kondhwa Campus.

Ref: Your P.O. No. 162/2009-10 dated 30/01/2010.

| SR. NO. | PARTICULARS | QTY | RATE | AMOUNT |
|---------|---|-------------------------------------|----------|----------------------|
| 1. | Planting large flowering/shady trees:- Digging pit with size 0.9m x 0.9m x 0.9m, removing and conveying unwanted stuff to a required distance as directed. Filling the pit with approved excavated material upto a height of 0.3m and remaining height of 0.6m with fresh garden soil and manure in proportion. Mixing garden soil and manure thoroughly well, leveling, watering on previous night, planting one to two year old healthy trees sapling as per specifications. Maintaining till well established (i.e. 6 months period) by watering, weeding, stirring of soil replacing of casualties etc. complete. | ✓ 69 No. | ✓ 437.00 | ✓ 30153=00 |
| 2. | Preparing Shrubbery:- Excavating the Ground to a required depth of 30cms, removing and conveying unwanted stuff to a required distance as directed. Filling fresh garden soil & manure in excavated area in 3:1 proportion to a height of 30cms. Mixing garden soil and manure thoroughly well, leveling and watering on previous night. Planting well-rooted shrubs 0.5mts apart as directed and maintaining till well established (i.e. 6months period) by watering, weeding, stirring, replacing casualties, etc. complete. | 98.00 sq.mt. 116.00 sq.mt. | 308.00 | 30184=00 35728=00 |

Pl check
Sh. Jha

SINHAGAD TECHNICAL EDUCATION SOCIETY
PROJECT DEPT.

Inward No. : 335

Bill Received On : 27-10-10

Received By :

Signature : P.S. Ingle

GREEN GRAPH

Plot No 3, Survey No 216, Baner, Pune, 411045

| | | | | |
|---|--|---------------|----------|------------------|
| 3. | Bougainvillea Creepers Plant:- Excavating pit with size 0.30m x 0.300m x 0.300m removing & conveying unwanted stuff to required distance as directed. Filling the pit with approved excavated material upto height of 0.15m with fresh garden soil and manure in 3:1 proportion. Mixing soil and manure thoroughly well, leveling watering on previous night. Planting one or two year old healthy plant as per specifications. Maintaining till well established (i.e. 6months period) by watering, weeding, pruning, stirring, replacing casualties etc. complete. | ✓ 45.00 No | ✓ 120.00 | ✓ 5400=00 |
| Total Rs. (Sixty five thousand seven hundred thirty seven) | | | | 65,737=00 |

te: Measurement Sheet Attached.

Rs 71281=00

For Green Graph,

Proprietor

Thanking You,

Measurement & bill checked.

Final bill Amt: Rs 72281=00

(Rs Seventy-two thousand two hundred eighty one only)

Signature...
P. B. Joshi
Date... 26/10/10...



TREE PLANTATION AT HOSTEL PREMISES AT KUNDHAVA.

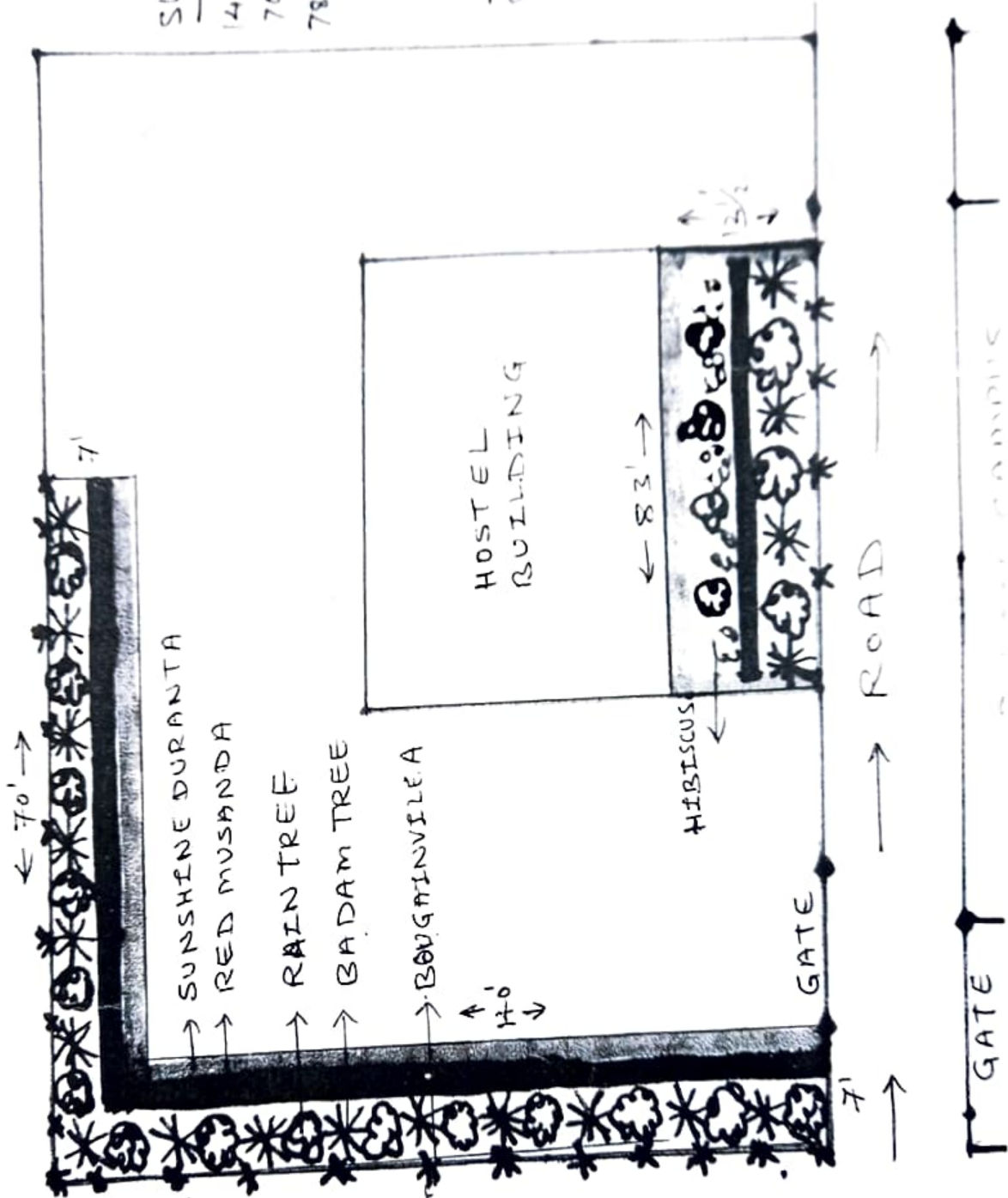

Shrubbery
 $140 \times 3 = 420$
 $70 \times 3 = 210$
 $78 \times 8 = 624$

 = 254
 20.18
 2.6 sq. mtr
 P. J. J.

- A) TREES
 1) BADAM - 33 NO.
 2) Rain tree - 36 NO.
 69 NO.

B) Shrubbery
 Area - 1520 sq. ft
 Pedu. 414.00 force
 45.00 creper

 459.00

net: 1061 sq. ft
 i.e. 58 sq. mtr.
 71.74
 C) Bougainvillea
 (45) NO.
 475

net = 201
 205 - 950
 150



SINHGAD TECHNICAL EDUCATION SOCIETY

(Regd. No. MAH/7199-93 / Pune dt. 6/7/93 & F-8282 (Pune) dt. 12/8/93)

19/15, Erandwane, Smt. Khilare Marg, Off. Karve Road, Pune - 411 004 Telefax : (020) 2545 4008 Email : stes@sinhgad.edu

PROF. M. N. NAVALE
M.E. (ELECT.) MIE., MBA.
FOUNDER PRESIDENT

DR. (MRS.) SUNANDA M. NAVALE
B.A., MPM, Ph.D.
FOUNDER SECRETARY

P.O.No.P - 162 /09-10

Date :- 30.01.2010

To,
Green Graph
Plot No 3,
Survey No. 216, Baner,
Pune :- 411 045

Sub :- Plantation and Garden Development for S.T.E. Society at Kondhwa.
Ref: Your Offer No Nil dated 27.01.2010

Dear Sir,

We refer to above and the discussion you had with our Project Manager and we have pleasure in placing the Work Order for the above mentioned works at the rates quoted by you.

The rates as indicated in the annexure shall be initially valid for the period of one year from the date of commencement of work i.e. from 1st February 2010 to 31st January 2011, to be renewed from year to year on the mutually agreed rates.

The undersigned, agrees with the estimated cost of Rs.10,89,739.00 (Rupees Ten Lacs Eighty Nine Thousand Seven Hundred Thirty Nine Only.) as per Annexure - I enclosed. However, the payment shall be made as per the actual measurements jointly recorded and accepted.

The rates includes with material, plants, soil, labour etc. and Six (06) months free maintenance cost.

If mortality occurs replacement of plants will be given free of cost, the plant should be of good quality, vigorous, erect and healthy condition.

15% Retention amount shall be retained from your bills and the same shall be released to you after Ten months.

The unit rate quoted is inclusive of all taxes and nothing extra shall be payable.

Please return copy of this Work order with Annexure - I duly signed in token of your acceptance.

Thanking you,

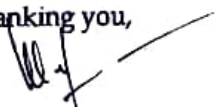
M.N.NAVALE
PRESIDENT
Encl : Annexure - I



Tree Plantation and Garden Development for STES at Kondhwa Campus.

BILL OF QUANTITIES

| Nos. | Description | Unit | Qty. | Rate | Amount |
|---------------------|--|---------|---------|--------|---------------------|
| 1 | Planting large flowering/shady trees. Digging pit with size 0.9m x 0.9m x 0.9m, removing and conveying unwanted stuff to a required distance as directed. Filling the pit with approved excavated material upto a height of 0.3m and remaining height of 0.6m with fresh garden soil and manure in proportion. Mixing garden soil and manure thoroughly well, leveling, watering on previous night. planting one to two year old healthy trees sapling as per specifications. Maintaining till well established (i.e. 6 months period) by watering, weeding, stirring of soil replacing of casualties etc. complete. | Nos. | 250.00 | 437.00 | 109250.00 |
| 2 | Preparing Shrubbery: Excavating the Ground to a required depth of 30cms, removing and conveying unwanted stuff to a required distance as directed. Filling fresh garden soil and manure in excavated area in 3:1 proportion to a height of 30cms. Mixing garden soil and manure thoroughly well, leveling, watering on previous night. Planting well rooted shrubs 0.5mtrs apart as directed and maintaining till well established (i.e. 6 months period) by watering, weeding, stirring, replacing casualties, etc. complete. | Sq.mtr. | 300.00 | 308.00 | 92400.00 |
| 3 | Bougainvillea Creepers Plant: Excavating pit with size 0.30m x 0.30m x 0.30m removing and conveying unwanted stuff to required distance as directed. Filling the pit with approved excavated material upto height of 0.15m with fresh garden soil and manure in 3:1 proportion. Mixing soil and manure thoroughly well, leveling watering on previous night. Planting one or two year old healthy plant as per specifications. Maintaining till well established (i.e. 6 months period) by watering, weeding, pruning, stirring, replacing casualties etc. complete. | Nos. | 115.00 | 120.00 | 13800.00 |
| 4 | Providing Brick - Bat: Providing and spreading of brick-bat and crushing of required size. | Sq.mtr. | 2467.00 | 50.00 | 123350.00 |
| 5 | Preparing Lawn (30 cms): Excavating the Ground to a required depth of 30cms, removing and conveying unwanted stuff to a required distance as directed. Filling fresh garden soil/silt & manure in excavated area in 3:1 proportion to a height of 30cms. Mixing garden soil and previous night. Planting required variety of lawn grass as directed and maintaining till well established (i.e. 6 months period) by watering, weeding, clipping, rolling etc. complete. | Sq.mtr. | 2467.00 | 267.00 | 658689.00 |
| 6 | Planatation of Raphis Palm: Plantation of Raphis palm bed surrounding the building wall including filling of soil and organic manure. | Nos. | 135.00 | 350.00 | 47250.00 |
| 7 | Potted Plants: Potted plants including good quality plastic pots (size14") ornamental and decorative plants. | Nos. | 150.00 | 300.00 | 45000.00 |
| Total Amount | | | | | 1,089,739.00 |

(Rupees Ten Lacs Eighty Nine Thousand Seven Hundred Thirty Nine Only.)



Employer

Contractor

Journal Voucher

No. : 193

Dated : 15-Dec-2010

| Particulars | Debit | Credit |
|--|-----------|-----------|
| Samgir Plot Garden Maintenance <i>Dr</i> | 71,281.00 | |
| To STES-Corporate Office | | 71,281.00 |
| | 71,281.00 | 71,281.00 |

On Account of :

Bering Gaden development
and tree plantation work
done at Samgir Plot Boys
Hostel (Hostel Building) as
per map attached

1
Authorised Signatory



SINHGAD TECHNICAL EDUCATION SOCIETY

S N 44/1 VADGAON (BK)

OFF SINHGAD ROAD

PUNE 411 041

(2)

Journal Voucher

| No | Particulars | Dated | Debit | Credit |
|----|---------------------|-------------|-----------|--------------|
| | STES KONDHWA | 15-Dec-2010 | 71,281.00 | |
| | To TDS GREEN GRAPH | | | 713.00 |
| | To GREEN GRAPH | | | 70,568.00 |
| | New Ref 2ND & FINAL | | | 70,568.00 Cr |

On Account of :

TREE PLANTATION AND
GARDEN DEVELOPMENT
WORK DONE AT
KONDHWA CAMPUS.

71,281.00

71,281.00

Hemangi

Authorised Signatory



Garden development work Done at Sangis plot
Boys HOSTEL, as per discussion with Mr.
parisir CEO & ^{Mr} Khutwad.